

図面／規格
 【Ryomaru key (new JIS (made by Himeno))】

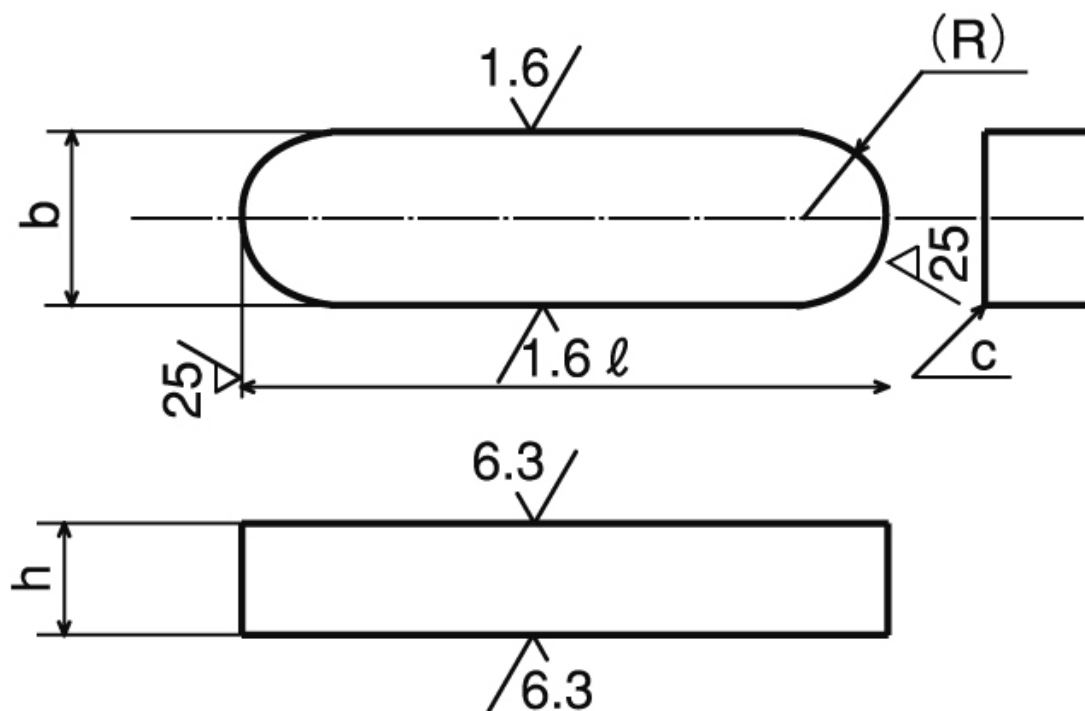

キーの 呼び寸法 (b × h)	b		h		c
	基準 寸法	許容差 (h9)	基準 寸法	許容差	
3 × 3	3	0 -0.025	3	0 -0.025	h9 0.16 ~0.25
4 × 4	4	0	4	0	
5 × 5	5	-0.030	5	-0.030	h9 0.25 ~0.40
6 × 6	6	0	6	0	
7 × 7	7	-0.036	7	0	h11 0.40 ~0.60
8 × 7	8	0	7	0	
10 × 8	10	-0.043	8	-0.090	h11 0.60 ~0.80
12 × 8	12	0	8	0	
14 × 9	14	-0.052	9	-0.110	h11 1.00 ~2.00
15 × 10	15	0	10	0	
16 × 10	16	-0.062	10	-0.130	h11 1.00 ~2.00
18 × 11	18	0	11	0	
20 × 12	20	-0.062	12	-0.130	h11 1.00 ~2.00
22 × 14	22	0	14	0	
24 × 16	24	-0.062	16	-0.130	h11 1.00 ~2.00
25 × 14	25	0	14	0	
28 × 16	28	-0.062	16	-0.130	h11 1.00 ~2.00
32 × 18	32	0	18	0	
36 × 20	36	-0.062	20	-0.130	h11 1.00 ~2.00